



## GEORGIAN VILLAGE TAKING SHAPE

No longer just an open field, 101 Thompsons Road has graduated to a full-fledged construction site.

The first floor is now complete in all seven blocks, as is the framing of some of the Garden Homes on the Edward St. side, making up almost the whole footplate of Georgian Village.

With slab-on-grade concrete pours completed, structural steel is now underway on the second and third

floors. The installation of precast floors and masonry walls continue on the second floor. Now that the ground, or first floor, is 99 per cent completed, window installations will begin shortly.

The excavation, underground works, slab-on-grade concrete, and framing is completed on the East Garden Homes. Framing on the west is anticipated to take place over the coming weeks.

Parking lot asphalt has been completed to base coarse and concrete curbs are poured. The turning lane addition to Thompsons Road is now completed and operational.

Armor Stone and landscaping of the pond area is beginning and is expected to be finished soon.

Sloped trusses and roof decking is beginning in the main common area (Block A) and the Long Term Care support services area (Block B).

# Georgian Village

*Relax, You're Home*



## SITE WORK STATUS:

### Block A

*Rendezvous, LTC Admin, Adult Day*

- Above grade masonry 90%
- Electrical rough-ins 90%
- Structural steel 98%

### Block B

*LTC Support*

- Plumbing and electrical underground 98%
- Slab on grade 95%
- Structural steel 99%
- Above grade masonry 97%

### Block C

*LTC RHA*

- 1st floor structural steel 100%
- 1st floor masonry 100%
- 2nd floor precast 85%
- 2nd floor masonry 10%

### Block D

*LTC RHA*

- Plumbing and electrical underground 95%
- Slab on grade 95%
- 1st floor structural steel 85%
- 1st floor masonry 85%

### Block E

*Affordable Housing*

- Backfill, underground plumbing, slab on grade, 1st floor masonry and structural steel 100%

- 2nd floor masonry 50%

### Block F

*Life Lease*

- 2nd floor precast and balconies 85%
- 2nd floor masonry 10%

### Block G

*Assisted Living*

- Slab on grade and structural steel 99%
- 2nd floor precast and terraces 100%
- 3rd floor precast and masonry 85%

### Garden Homes

- Underground plumbing and electrical 100%
- Slab on grade 50%
- Framing 50%
- Roofing 20%
- HVAC 20%

## GOING FORWARD

Efforts on site will continue to complete steel stud framing in Block F and G, Sloped trusses in Block A and G, Roof deck in Blocks A, B, and G; 2nd and 3rd floor precast in Blocks C, D, and G. Further, 3rd floor precast work in Block C and E and installation of stairs are expected to proceed. Garden homes will continue to frame, and trusses, roofing and window installations will continue.

## THE GEORGIAN MANOR REDEVELOPMENT

### PART OF BLOCK A

### LONG TERM CARE ADMINISTRATION & MAIN ENTRY AND RECEPTION AREA

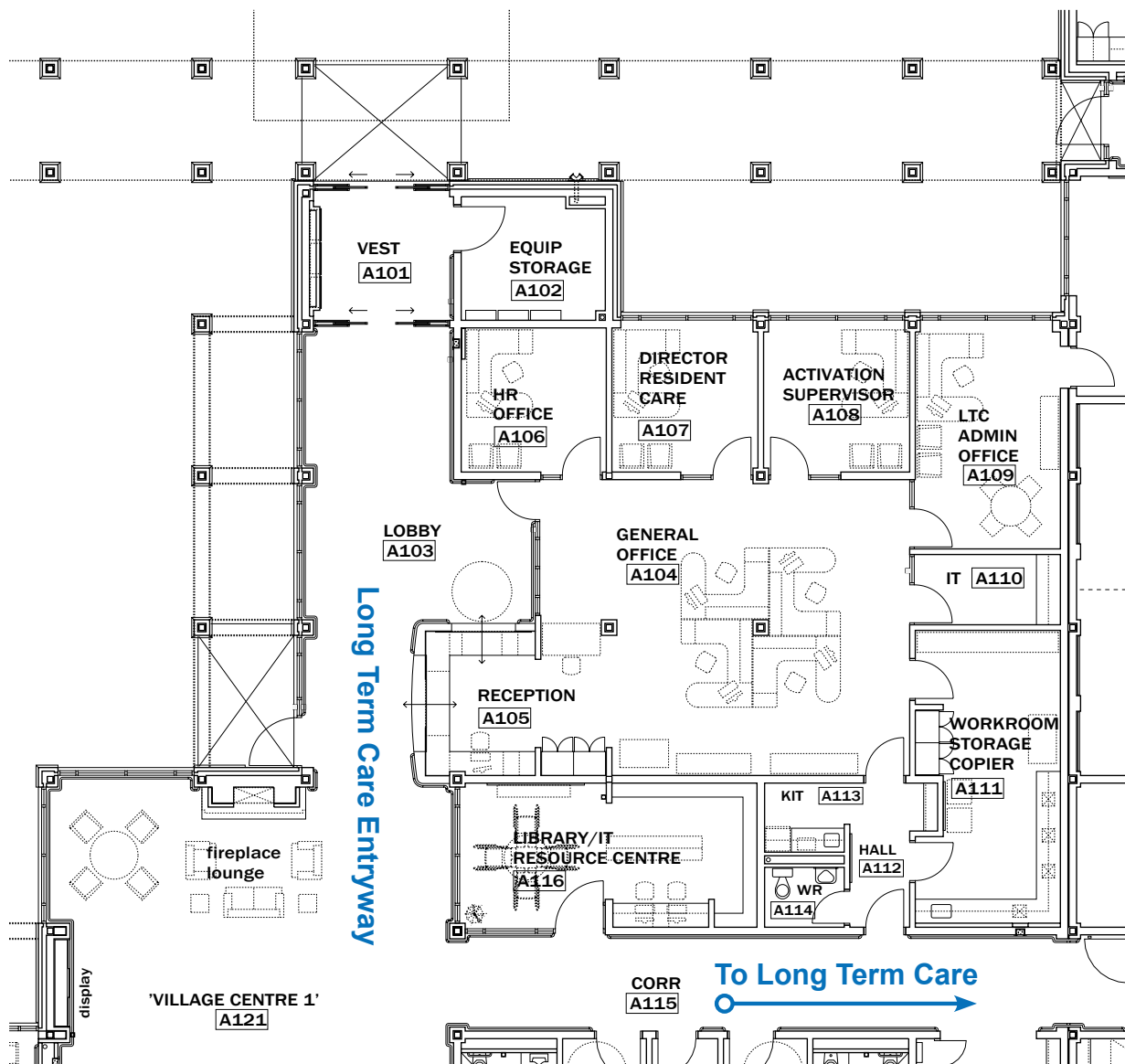

Although final room designations are still being assigned and confirmed by the Relocation Committee, this Administration and Reception area (part of Block A) is located beside the main entry to Long Term Care (Blocks C and D).

It also contains a communal Library/Computer Room and a Fireplace Lounge. Note that the Workroom #A111 is being revised to include a central partition wall which will provide more potential Community Programs office space and better utilize space in the Workroom.

## THE GEORGIAN MANOR REDEVELOPMENT

### PART OF BLOCK A SENIORS' CENTRE

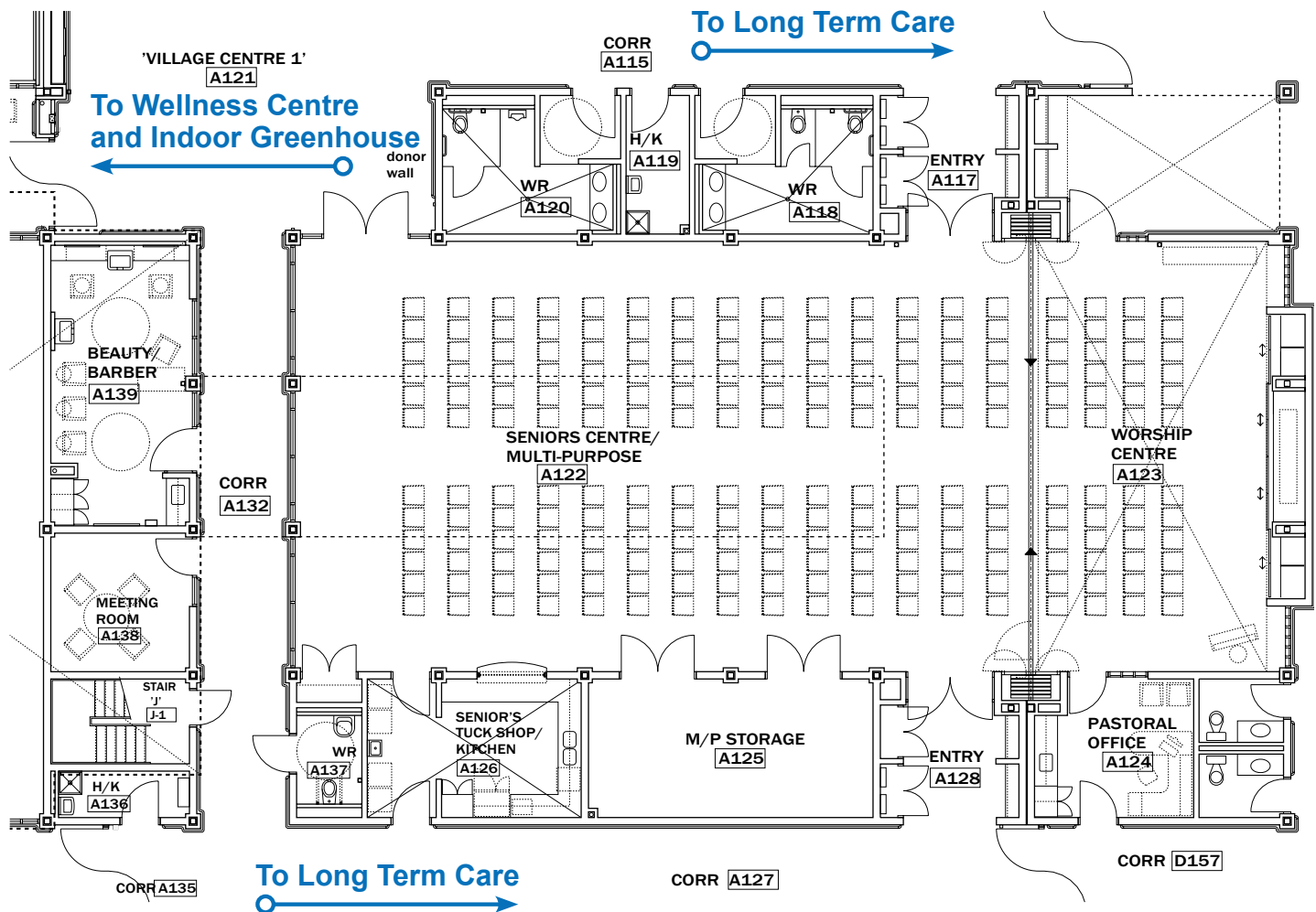

The Seniors' Centre/Multipurpose Hall is easily accessible by all residents.

It has been designed to allow separation from the Worship Centre by the use of a folding wall which will allow for multiple functions at one time.

As a larger room, it will be capable of seating more than 200 people.

A pastoral office has been conveniently placed directly south of the Worship Centre.

A camera has been placed at the Worship Centre (staging area) which will allow full worship services and events to be broadcast to all resident rooms and lounges.

All functions will be easily viewed on a large screen also located at the staging area.